



WORKFORCE LEADERS SYMPOSIUM 2024

Symposium

SEPTEMBER
17-18, 2024



WIND CREEK®
BETHLEHEM, PA

WORKforce

PA Workforce Development Association
The Voice of Pennsylvania Workforce Development



Post-Pandemic Coaching/Empowerment

A number of your employees and clients were affected by the pandemic. Consider booking Darrell Andrews LLC to help heal, motivate, and transform your workplace post-pandemic!

Are you looking to:

- Build a leadership culture that retains top talent?
- Equip career coaches and case managers to connect more effectively with post-pandemic clients?
- Implement systems that empower and energize your staff?
- Provide tools that help clients take ownership of their employment journey?

If so, let's connect and start driving success together!



Case Management Career Coaches!

- Motivational Interviewing.
- Motivational Coaching.
- Trauma Informed Care.
- On-Going Professional Development/Coaching.
- General Motivation.

Empower!



Post-Pandemic Leadership Coaching!

- PP Leadership Coaching.
- PP Leadership Training.
- Group Coaching.
- Assessments.
- One-Time Strategy Meeting.

Engage!



Success In The Workplace Client Workshops!

- Job Success Motivation.
- Job Readiness Training.
- Virtual or Live Sessions.
- On-Going Or One-Time.

Enlighten!

Our Offices!

Winter Park, FL and Wilmington, DE

Can We Chat?
 Schedule a discovery call!

302-559-4092

Websites

coachdspeaks.com
 selfcareempowered.com

TABLE OF CONTENTS

- **CONFERENCE MAP** - *Page 2*
- **AGENDA AT-A-GLANCE** - *Page 3*
- **PWDA CALENDAR OF EVENTS 2024-2025** - *Page 4*
- **PWDA POLICY & ADVOCACY** - *Page 5*
- **SPONSORS** - *Page 6*
- **SOLUTIONS-TALK ROUNDS** - *Page 7*
- **PANEL & KEYNOTE SESSIONS** - *Page 12*
- **EXHIBITORS & EXHIBIT HALL** - *Page 14*
- **NETWORKING - COCKTAIL HOURS** - *Page 16*
- **"AFTER HOUR" EVENTS** - *Page 17*
- **PWDA BOARD & STAFF** - *Page 18*

SPECIAL THANKS
TO OUR REGIONAL
HOST!

**WORKFORCE BOARD
LEHIGH VALLEY**

SYMPOSIUM MAP

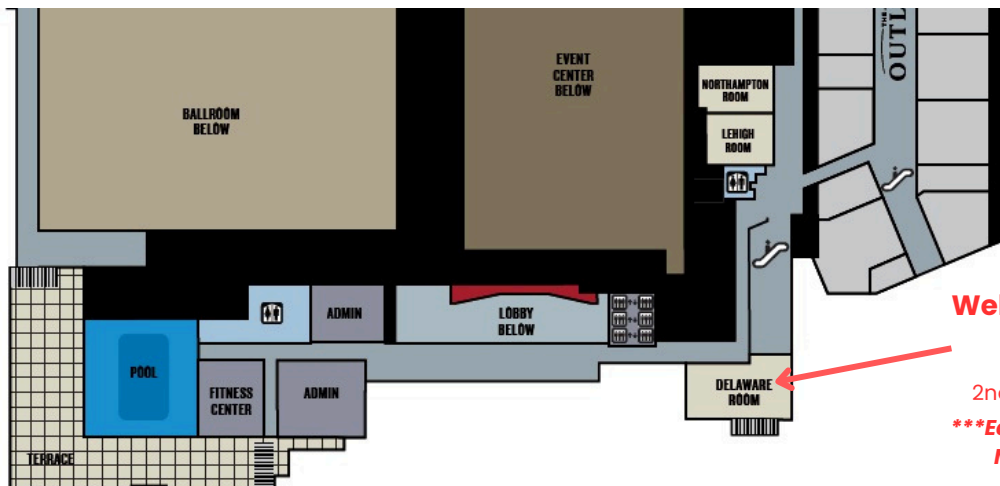

Welcome Cocktail Hour
 Monday, Sept. 16
 5-6pm
 2nd Floor - Delaware Room
*****Early Registration Available
 MONDAY 5pm-6pm*****

AGENDA AT-A-GLANCE

Monday, September 16

- 3:00pm-4:00pm PWDA Board Meeting (closed to public)
- **5:00pm-6:00pm Registration Open (at Cocktail Hour)**
- **5:00pm-6:00pm Welcome Cocktail Hour (open bar)**

Tuesday, September 17

- 7:30am-4:00pm Registration Open
- 7:45am-8:30am Breakfast
- 8:30am-5:30pm Exhibit Sponsor Tables Open
- 8:30am-9:45am Welcome & Lehigh Valley Aligned Panel
- 10:00am-11:00am SolutionsTalk - Round I
- **11:00am-11:15am Coffee & Networking Break**
- 11:15am-12:15pm SolutionsTalk - Round II
- 12:15pm-1:45 pm Lunch & ALICE Presentation
- **1:45pm-2:15pm Networking Break**
- 2:15pm-3:15pm SolutionsTalk - Round III
- **3:15pm-3:30pm Networking Break**
- 3:30pm-4:30pm SolutionsTalk - Round IV
- **4:30pm-5:30pm Social Power Hour**

Wednesday, September 18

- 7:30am-8:30am Registration Open & Breakfast
- 8:30am-10:30am Closing Session
- 10:30am Closing Remarks

After-Hours
LOCAL EVENTS
hosted by Workforce
Board Lehigh Valley



PLUS!!
On-the-Farm Training
hosted by the PA
Dept. of Agriculture



Upcoming
EVENTS

NOVEMBER 18-19, 2024

APPRENTICESHIP PA COLLABORATIVE & EXPO

MARCH 10-11, 2025

YOUTH WORKFORCE SUMMIT

APRIL 30-MAY 2, 2025

41ST ANNUAL CONFERENCE

FALL 2025

WORKFORCE LEADERS SYMPOSIUM

FALL 2025

APPRENTICESHIP PA COLLABORATIVE & EXPO

MORE DETAILS AT WWW.PAWORK.ORG



WORKforce

PA Workforce Development Association

POLICY & ADVOCACY

FELLOWSHIP PROGRAM

FELLOWSHIP
APPLICATION IS
OPEN!



SCAN ME

 **FREE**the**DATA**

**JOIN THE
COALITION
TODAY!**

EMAIL INFO@PAWORK.ORG



SPONSORS

TITLE SPONSOR

ETOWNGPS
ELIZABETHTOWN COLLEGE
SCHOOL OF GRADUATE & PROFESSIONAL STUDIES

PATRON SPONSOR

 **EQUUS**[®]
WORKFORCE SOLUTIONS

SAIDIS, SHULTZ & FISHER
• ATTORNEYS AT LAW •

SILVER SPONSOR

grant **A**ssociates

SOLUTIONSTALK

Presentation Rounds for Insight, Resources, and Connection
Tuesday September 17, 2024

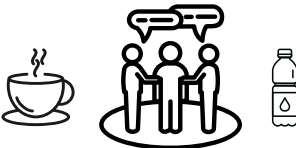
	Foundry F	Foundry G	Foundry J	Foundry H
Rd. 1 10:00am-11:00am	Light Bulb Moments TANF Reform and Benefits Cliff <i>(PhilaWorks)</i>	Building Bridges The Power & Influence of Work-Based Learning <i>(Lehigh Career and Technical Institute)</i>	Transformative Actions Embracing Core Values: A Blueprint for Leadership Excellence <i>(Coach D)</i>	Find all your resource and information gathering solutions in the Symposium Exhibit Space! BONUS! Water Coffee Snacks and more!
Rd. 2 11:15am-12:15pm	The Purpose & Impact of Longitudinal Data <i>(PA Longitudinal Data System)</i>	Building Pennsylvania's Credential Ecosystem <i>(PA State System of Higher Education)</i>	GOT IDEAS? <i>(Workforce Board Lehigh Valley)</i>	
Rd. 3 2:15pm-3:15pm	GPS Partnership Collaboration: Proven Success with Measurable ROI Results <i>(Elizabethtown College SGPS)</i>	Why Child Care is Inextricably Linked to Workforce <i>(The Pennsylvania KEY)</i>	The Employer's Blueprint for Innovative Workforce Strategies <i>(Chester County Economic Development Corp.)</i>	Foundry A 5-Star Workforce Data Tools and Gadgets <i>(Center for Workforce Information & Analysis)</i>
Rd. 4 3:30pm-4:30pm	How Investing in America Agenda can Provide RA Pathways for Opportunity Youth <i>(Safal Partners)</i>	Looking Abroad: Work, Skills, and Communities <i>(The New Possible/ Partner4Work)</i>	Identifying Strategic Partners <i>(PhilaWorks)</i>	Off-Site Tours and Events Available! Refer to Page

SOLUTIONSTALK

Presentation Rounds for Insight, Resources, and Connection

Tuesday, Sept. 17 | 10:00am - 11:00am

TANF Reform and Benefits Cliff | Foundry Ballroom F

Presenting policy research on the current state of TANF and how it can be improved to better serve its recipients, in addition to other items folks can advocate for to better address the structural causes of poverty. Additionally, an economic analysis on benefit cliffs for other public assistance programs, including SNAP, Medicaid and Childcare subsidies.

Max Robinson and Gloria Oh, Philadelphia Works

The Power and Influence of Work-Based Learning | Foundry Ballroom G

This session delves into the significant impact that work-based experiences have on high school students. Participants will explore the firsthand accounts of former career and technical education (CTE) students who engaged in work-based learning and how these experiences shaped their career or college pathways. The presenter will focus on common themes that developed over the course of a two part interview process with the participants. These findings stress the importance and influence that these participants place on their work based learning experiences with local employers. Attendees will leave with a deeper appreciation of the role that real-world experiences play in shaping future workforce members and how to better support these initiatives.

Darin Van Norman, Lehigh Career & Technical Institute

Embracing Core Values: A Blueprint for Leadership Excellence | Foundry Ballroom J

Dive into the foundational principles that form the bedrock of exceptional leadership: core values. We explore how leaders who are deeply rooted in their core values not only navigate challenges with grace but also inspire and uplift those around them. Drawing upon real-life examples and timeless wisdom, this presentation is a roadmap for aspiring leaders who seek to leave a lasting impact.

Darrell "Coach D" Andrews, Darrell Andrews LLC

Round 2

SOLUTIONSTALK

Tuesday, Sept. 17 | 11:15am - 12:15pm

The Purpose and Impact of Longitudinal Data | Foundry Ballroom F

Get an update from the Pennsylvania Longitudinal Data System (PALDS) office on their work with education, workforce development, and corrections. Take a glimpse at the latest research findings and explore future project opportunities.

Colby Claubaugh, Pennsylvania Longitudinal Data System

Building Pennsylvania's Credential Ecosystem | Foundry Ballroom G

With over a million unique credentials in the U.S. alone and nearly 60,000 providers of credentials the credential ecosystem is large, complex, and confusing. Linked open data enables the creation of online tools that help consumers plan and optimize their journeys. PASSHE is piloting the registry with Credential Engine to create a Credential Registry of education, training, and industry credentials to show pathways, transfer values and articulations, linkages to industry certifications, apprenticeships and occupations and powers online user tools and Learner and Employment Records (LERs). In this session we will discuss how this system streamlines data collection, breaks down silos, makes data accessible and actionable.

Hope Lineman and Natalie Cartwright, Pennsylvania State System of Higher Education

GOT IDEAS?...join the Lehigh Valley as we share workforce IDEAS, and invite you to share right back! | Foundry Ballroom J

Workforce Professionals: Join Chief Elected Officials and Workforce Board Lehigh Valley Directors for an opportunity to present new program ideas, program designs, innovative models, implementation strategies, costs, outcomes and sustainability.

Nancy Dischinat, Workforce Board Lehigh Valley

Round 3

SOLUTIONSTALK

Tuesday, Sept. 17 | 2:15pm - 3:15pm

GPS Partnership Collaboration: Proven Success with Measurable ROI Results | Foundry Ballroom F

Elizabethtown College School of Graduate and Professional Studies (SGPS) embarked on an initiative to become more connected with local and regional businesses to establish a working relationship in improving the needs of the workforce and community. SGPS will share in a case study format through a small panel discussion their partnership model, initial metrics, results, along with benefits from various perspectives.

Dr. Marcy McCarty, Chris D'Imperio, and Dave Woffington, Elizabethtown College, SGPS

Why Child Care is Inextricably Linked to Workforce | Foundry Ballroom G

Please join us for a practical, solutions-oriented session that examines the critical impact child care, or lack thereof, has on economic growth and stability. An array of tested solutions and resources will be provided during this session to empower communities and help them address local childcare gaps – these include promoting employer-based childcare programs and family-friendly policies, matching employers with external childcare programs, and more.

*Karen Grimm-Thomas, The Pennsylvania Key/Creative Child Care Solutions
Andrea Heberlein, PA Early Learning Investment Council*

The Employer's Blueprint for Innovative Workforce Strategies | Foundry Ballroom J

Game-changing toolkits for leadership readiness for change. This workshop empowers leaders to transform and re-imagine the people side of workforce development. Participants will explore topics covered by the toolkits, including actionable steps for assessing leadership readiness, enhancing employee engagement, and attracting diverse talent to align with your organization's mission.

*Patti VanCleave, Chester County Economic Development Council
Stephanie Smith, Chester County Workforce Development Board
Maria O'Connell, People ACCEL Solutions*

5-Star Workforce Data Tools & Gadgets | Foundry Ballroom A

Gathering and analyzing data can be overwhelming. Learn about CWIA's newest and coolest products available to help you make informed workforce development decisions.

Kim DeLellis and Ed Legge, PA Center for Workforce Information & Analysis

Round 4

SOLUTIONSTALK

Tuesday, Sept. 17 | 3:30pm-4:30pm

How the Investing in America Agenda Can Provide RA Pathways for Opportunity Youth | Foundry Ballroom F

The Investing in America Agenda represents a historic commitment to workforce development with hundreds of billions of dollars earmarked for our nation's infrastructure, semiconductor industry, and renewable energy sector over the coming years. This substantial investment will necessitate the training of millions of new workers in innovative industries to fill these roles. Join us to hear from U.S. DOL and its' Registered Apprenticeship Center of Excellence about the core elements of the Investing in America Agenda, what opportunities exist related to how States can utilize funding opportunities to support registered apprenticeship, and how organizations can collaborate to support the implementation of the Agenda while also supporting Opportunity Youth.

Alan Dodkowitz, Safal Partners

Looking Abroad: "Work, Skills and Communities" | Foundry Ballroom G

In August 2024, workforce development and philanthropy partners from Pittsburgh joined the U.S. Delegation to Manchester, United Kingdom to experience the Employment and Skills Landscape in the City of Manchester and its boroughs, including suburban and rural areas. This session shows what is newly possible by working with City Leaders and Economic Development, maximizing the involvement of community organizations, and re-imagining the delivery of local services. Pack your bags and grab your passport, we have a story to share!

Natalie Branosky, The New Possible

Rob Cherry, Partner4Work

Identifying Strategic Partners for Expanded Capacity | Foundry Ballroom J

This workshop is for workforce leaders who want to leverage existing or create new partnerships to create and scale quality programs in their local area/region.

Ashlee Phillips and Kaila Shannon, Philadelphia Works, Inc.



Lehigh Valley ALIGNED!

Tuesday, Sept. 17 at 8:30am-9:45am

Nancy Dischinat, Executive Director of the Workforce Board Lehigh Valley, presents a panel showcasing Lehigh Valley's alignment of economic development, workforce development, education, community planning, government and business.



Nancy Dischinat
Workforce Board
Lehigh Valley



Donald Cunningham Jr.
Lehigh Valley Economic
Development Corporation



Becky Bradley
Lehigh Valley
Planning Commission



Dr. Carol D. Birks
Allentown
School District



Tony Iannelli
Greater Lehigh Valley
Chamber of
Commerce



Lamont G. McClure
Northampton County
Executive



Phillips M. Armstrong
Lehigh County
Executive

ALICE...Meet Workforce Development

Tuesday, Sept. 17 at 12:30pm-1:30pm

"Asset Limited, Income Constrained, Employed" - Did you know that 41% of working Pennsylvania Households earn less than the ALICE and Federal Poverty Level (FPL) thresholds? What is ALICE and how does it relate to your workforce development plans, priorities, and needs? Learn the latest information about Pennsylvania's workers who struggle to financially survive, discuss opportunities for workers to improve their livelihood (increase their employment success!), and explore how the United Way of PA and PWDA are working together to support local efforts.



Phil Falvo
United Way of
Pennsylvania



Legislative Watch

The Latest on WIOA, TANF, Pennsylvania initiatives, and more



Chris Andresen
Dutko Government Relations

Wednesday, Sept. 18 at 8:30am-9:30am

Hear up-to-date information on U.S. Congressional discussions impacting workforce development and related education and training initiatives, including WIOA Reauthorization, Appropriations, TANF regulations, and more. Gain insight into Pennsylvania's divided legislature and Administration for workforce, apprenticeships, labor, education & training, and more. Explore what action you can take with PWDA to advocate and educate about the success of Pennsylvania's workforce development system.



H. Patrick Clancy
Philadelphia Works

Rebecca O'Shea
PWDA
Moderator



Workforce Development IS Economic Development

Exploring Priorities and Alignment

Wednesday, Sept. 18 at 9:30am-10:30am

As the job market continues to tighten, and the need for economic competitiveness remains, listen in on economic development priorities, engage in discussion, and address opportunities that align the human (workforce) capital.



Gwen Ross
PA Dept. of Community & Economic Dev.



Michael Rivera
Berks County Commissioner/
County Commissioners
Association of PA



Anna Ramos
Lancaster County
Workforce Dev. Board



EXHIBITORS

FOUNDRY BALLROOM H



United Way
of Pennsylvania



NETWORKING

Welcome Cocktail Hour

Monday, September 16
5:00pm–6:00pm

Delaware Meeting Room (2nd Floor)

Join us for appetizers
and an open bar.



Social Power Hour

Tuesday, September 17
4:30pm – 5:30pm

Foundry Ballroom H (Exhibitors Hall)

Get 1 free drink ticket and
join us for appetizers and drinks

Sponsored by:
ETOWNGPS
ELIZABETHTOWN COLLEGE
SCHOOL OF GRADUATE & PROFESSIONAL STUDIES



AFTER HOUR EVENTS

Advanced Registration Required | Space is Limited

Bowery Farming **"On The Farm" Tour**

Tuesday, September 17 - 3:00pm-4:30pm

Join the PA Department of AG for a tour of the Bowery Farm and to learn more about the CEA and the industry's workforce needs!

To sign up to take the tour, please scan the QR Code to sign up



SCAN ME

On-the-Farm Training
hosted by the PA
Dept. of Agriculture



Da Vinci Science Museum

Tuesday, September 17 - 5:15pm -7:00pm

Tour the Da Vinci Science Center Transportation to the Da Vinci Science Center tour will be provided

To sign up for FREE tickets, please scan the QR Code to sign up



SCAN ME

**Hosted by the Workforce
Board Lehigh Valley!**



IronPigs vs. Red Sox Baseball Game

Tuesday, September 17 - 6:45pm

Enjoy a night of baseball as the Lehigh Valley Iron Pigs take on the Worcester Red Sox

To sign up for FREE tickets, please scan the QR Code to sign up.



SCAN ME



PWDA Board of Directors

OFFICERS

CHAIR Ami Gatts, President | Southwest Corner Workforce Development Board

VICE CHAIR Mary Salony, Executive Director | Tri-County Workforce Investment Board

TREASURER Anna Ramos, Executive Director | Lancaster County Workforce Development Board

REPRESENTATIVE Jennifer Butler, Executive Director | MontcoWorks

REPRESENTATIVE Gregg Dogan, Chief Administrative Officer | West Central PA Job Partnership

REPRESENTATIVE Jesse McCree, CEO | SCPA Works

AT-LARGE

Billie Barnes, Executive Director | County of Bucks Workforce & Economic Development

Robert Cherry, CEO | Partner4Work

H. Patrick Clancy, President & CEO | Philadelphia Works

Nancy Dischinat, Executive Director | Workforce Board Lehigh Valley

Melissa Fleming, Deputy Director | Northern Tier Workforce Development Board

Dan Fogarty, COO & Director | Berks County Workforce Development Board

Sam Hellen, Executive Director | Poconos Workforce Development Board

Patricia Lenahan, Executive Director | Luzerne-Schuylkill Workforce Investment Board

Kate McGeever, Director | Delaware County Workforce Development Board

Lisa Miller, Director | NWPA Job Connect

Erica Mulberger, Executive Director | Advance Central PA

Jeannette Roman, Director | Chester County Workforce Development Board

Jennifer Sklodowski, Director | Southern Alleghenies Workforce Development Board

Pam Streich, Director | Workforce Solutions for North Central PA

Virginia Turano, Executive Director | Lackawanna County Workforce Development Board

Janet Ward, Executive Director | Westmoreland-Fayette Workforce Development Board

Staff

Carrie Amann, MPA, CAE | Executive Director

Rebecca O'Shea, MPA | Director of Workforce Initiatives

Lisa Moyer | Training & Events Coordinator



PA Workforce Development Association

PA Workforce Development Association (PWDA) serves as the voice of the Pennsylvania workforce development system and a clearinghouse for workforce development information statewide. Known for Pennsylvania's premier annual workforce development gathering every spring, we provided development and capacity-building opportunities to workforce development professionals, local workforce development boards (WDBs), and other stakeholders while continuing proactive advocacy efforts on behalf of Pennsylvania's workforce development system.

205 House Ave, Suite 101 | Camp Hill, PA 17011



PA Workforce Development Association



www.pawork.org



info@pawork.org



[@paworkforce](https://www.instagram.com/paworkforce)

PWDA

SAVE THE DATE

41ST
annual
conference

APRIL 30-MAY 2, 2025

hershey lodge & convention center

www.pawork.org



WORKforce

PA Workforce Development Association
The Voice of Pennsylvania Workforce Development